

Connecting You to

Economic, Enterprise & Tourism  
Development Department

Mr Anthony Marston  
Marston Planning Consultancy  
23 Grange Park  
Foxrock  
Dublin 18

Date: 12 Nov 2020

**WITHOUT PREJUDICE  
SUBJECT TO CONTRACT/CONTRACT DENIED**

Dear Anthony

**Re: Proposed Grant of Consent to include lands in the ownership of the Council in a planning application to An Bord Pleanála to facilitate a proposed Strategic Infrastructure Development at Grange Castle Business Park – routing of cables to connect into the Grange Castle substation**

I refer to your request, on behalf of Edgeconnex Ireland Ltd., to include lands in Council ownership in a proposed planning application.

I now wish to confirm that South Dublin County Council hereby grants its consent to include lands outlined in red on attached Drawing No. 20\_167-CSE-GEN-ZZ-DR-C-2120 in a planning application for the purposes outlined above.

Please note that this consent does not convey to Marston Planning Consultancy or their client, Edgeconnex Ireland Ltd., any interest whatsoever in the subject lands and is for the sole purpose of allowing a planning application to be made.

This consent is valid for a period of twelve months from date of this letter.

The consent is conditional on no development taking place until full planning permission has been granted and the Council is in a position to enter into an appropriate agreement with Edgeconnex Ireland Ltd. in respect of the lands.

Yours sincerely

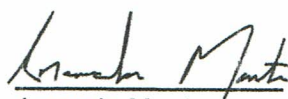

Amanda Martin  
Senior Staff Officer  
Development Section

Encl

**LEGEND:**

- PLANNING BOUNDARY
- PROPERTY BOUNDARY
- PROPOSED 110KV GRANGE CASTLE TO COOLDEIRING N+1 CIRCUIT
- PROPOSED 110KV GRANGE CASTLE TO COOLDEIRING N+2 CIRCUIT
- PROPOSED FUTURE 110KV DUCTING
- PROPOSED COMMS CABLES
- EXISTING 110KV UNDERGROUND CIRCUITS
- EXISTING 110KV UNDERGROUND CIRCUITS
- EXISTING PUBLIC LIGHTING LINES
- EXISTING GREEN FINGER
- COOLDEIRING SUBSTATION COMPANDED AREA CONSTRUCTION AS PERMITTED UNDER S202 REG. 107 (2) (B) (2)

**NOTE:**

1. ALL WORKS SHOWN ON THIS DRAWING ARE TO BE CONSIDERED AS PERMITTED UNDER S202 REG. 107 (2) (B) (2) OF THE LOCAL GOVERNMENT (PLANNING AND DEVELOPMENT) ACT 2002. THE CURRENT ALARMINGS WILL BE ADMITTED TO BEIT ACCORDINGLY.

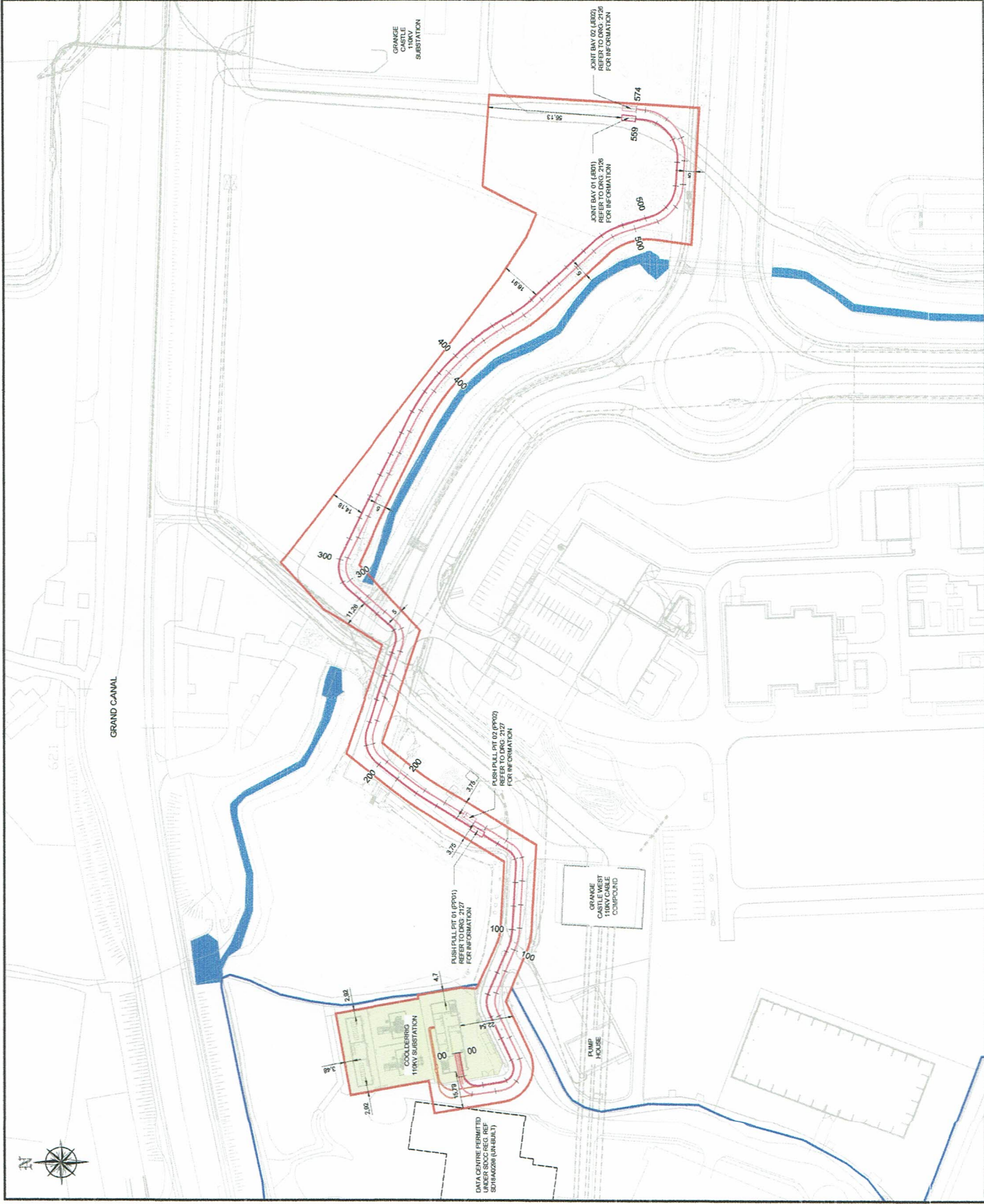

Rev	Description	Drawn	Checked	Date
R03	ISSUE FOR PLANNING	DW	EV	01.04.21
R02	FOR DISCUSSION	DW	EV	01.04.21
R01	FOR DISCUSSION	-	-	-

**Clifton Scannell Emerson Associates**

**BCEI**

**EDGECONNEX SUBSTATION 110KV CABLE ROUTE OVERALL PROPOSED GRID ROUTE PLAN**

Drawn By: DW Date: MAR 2021 20\_167  
 Checked By: RG Scale: 1:750@A1  
 Project Code: 20\_167@A1  
 Originator: Type: Role: Date: No.  
**20\_167 - CSE - GEN - ZZ - DR - C - 2120**

**S2** FOR INFORMATION  
 Status Code: Submitter Description: Planning  
 P03  
 Revision: Project Issue: PLANNING